

DETALHAMENTO BOCA DE LOBO

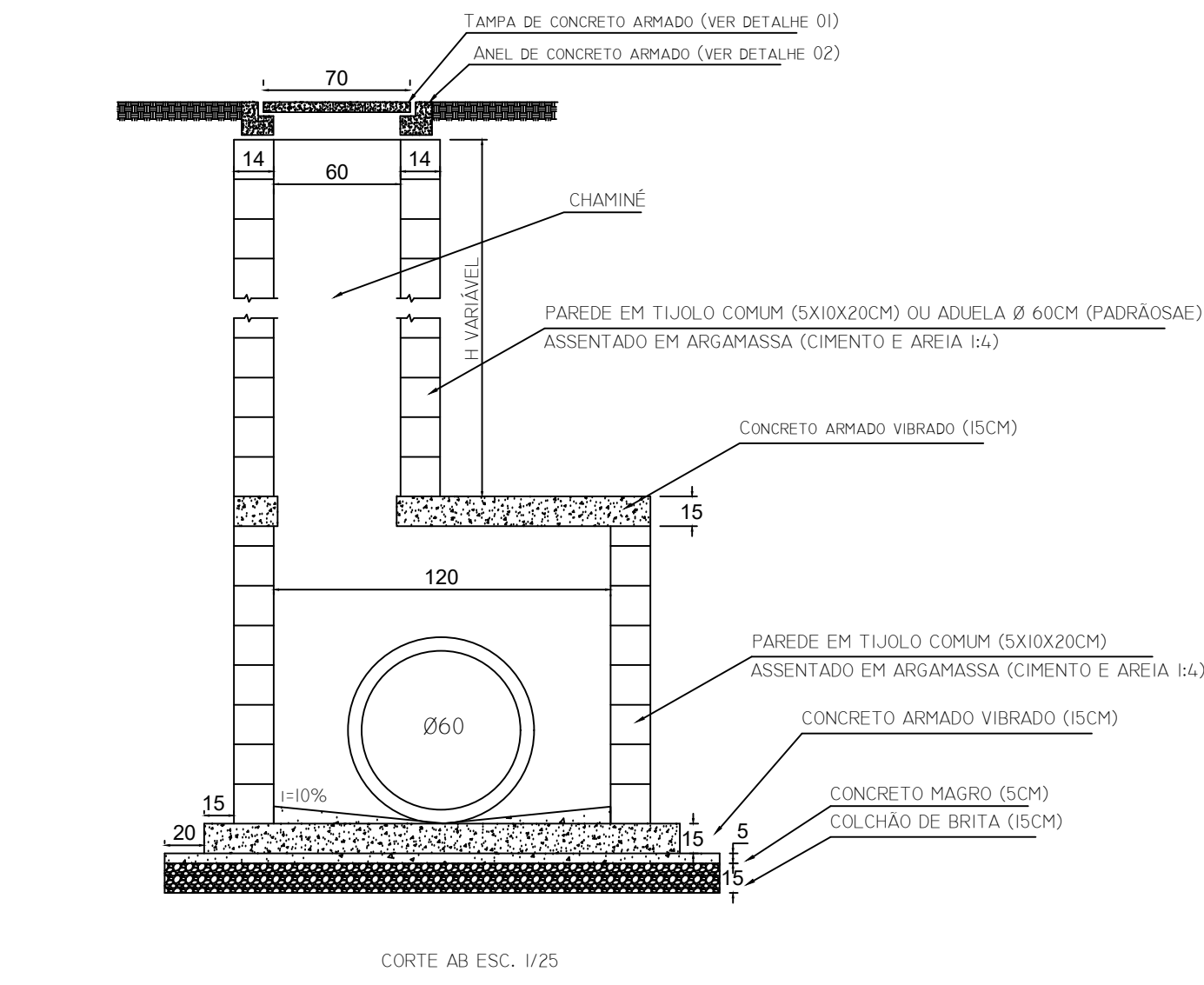
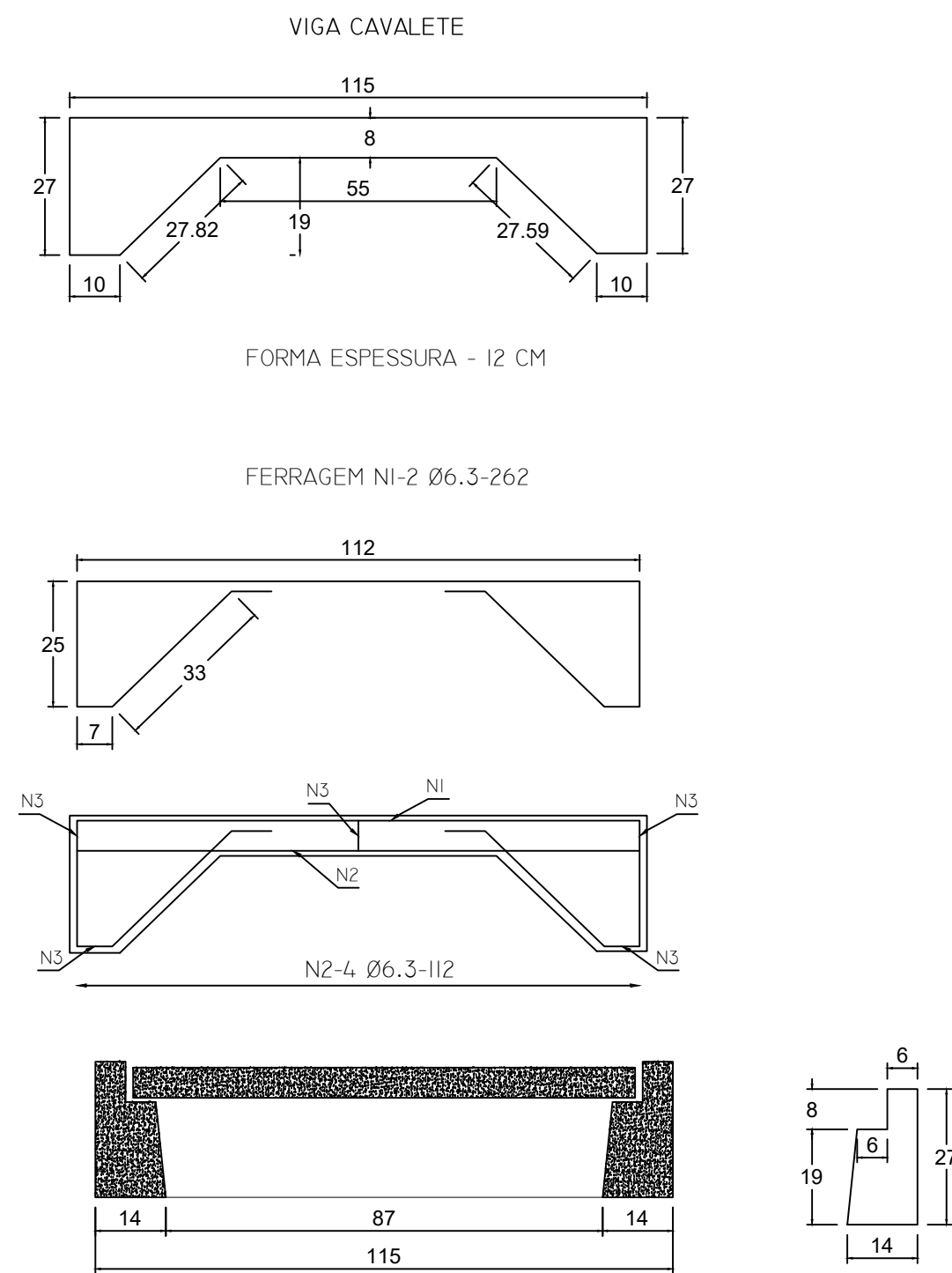
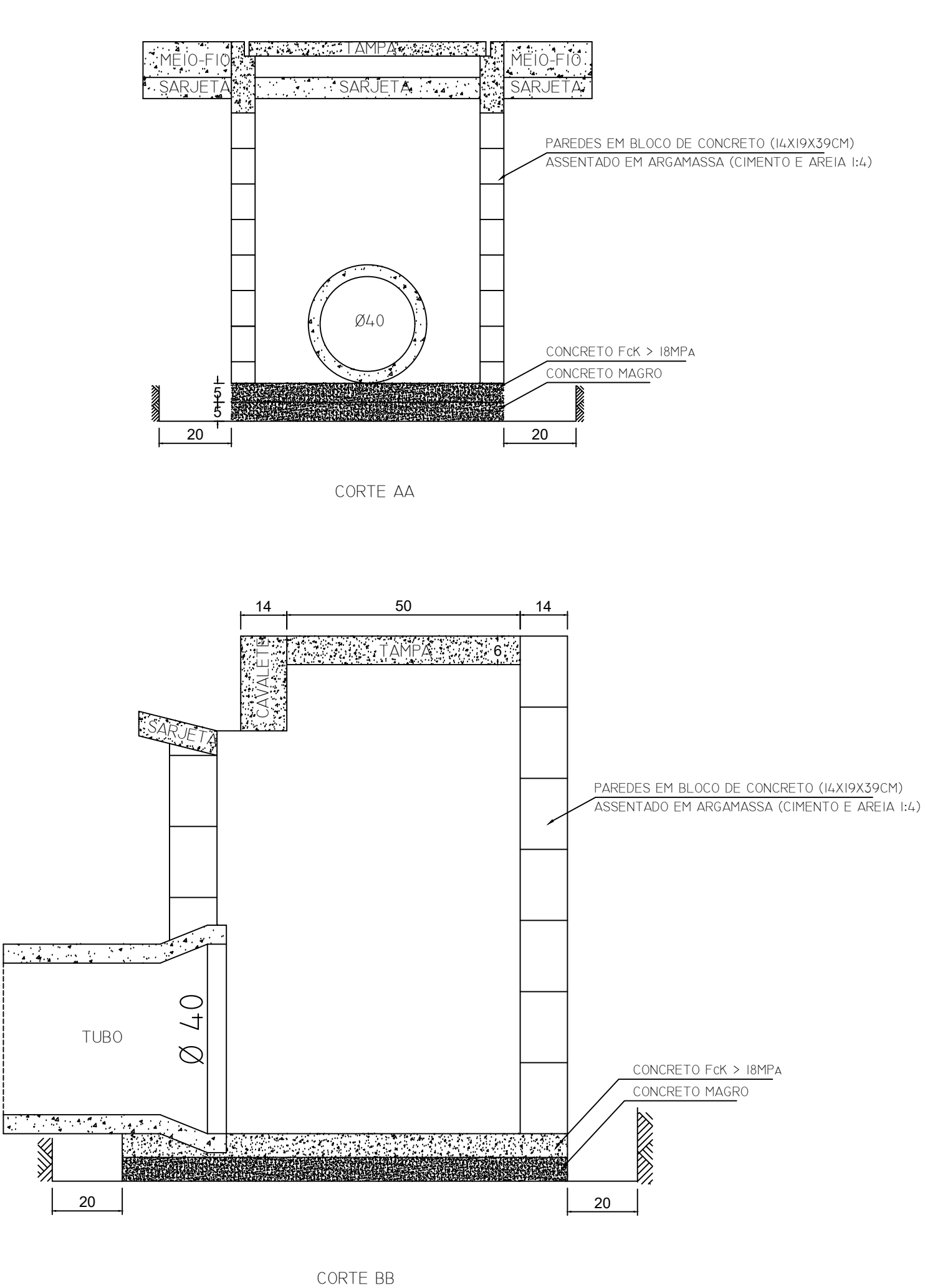
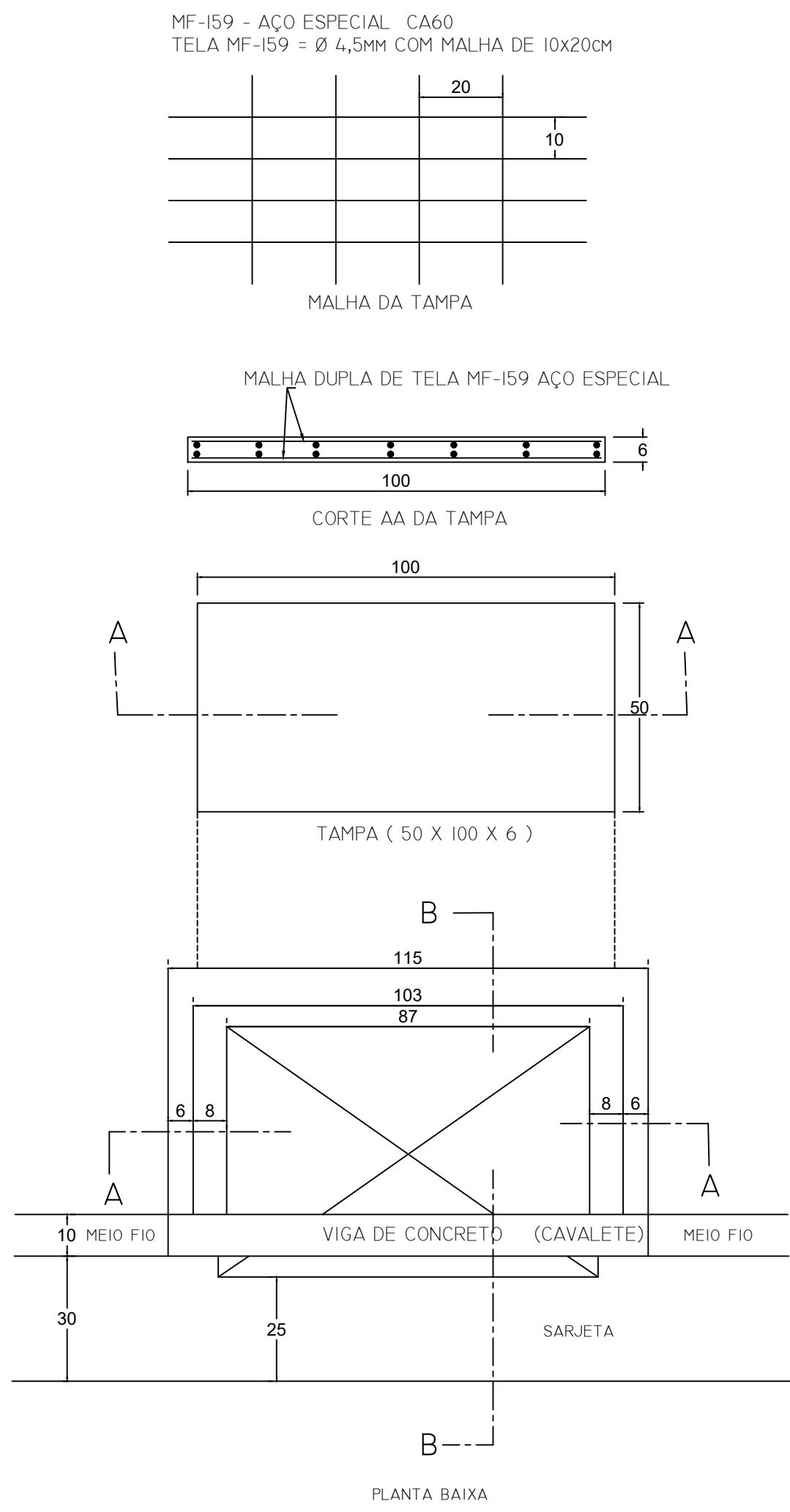

- POÇO DE VISITA EM BLOCO DE CONCRETO (14X19X20CM) PARA SAÍDA EM TUBO Ø 40 CM
(CONCRETO DO BLOCO FCK > 20 MPa)
- DIMENSÕES INTERNAS DA CAIXA: 100 X 100 CM

POSICAO	QUANT	#	UNID(M)	TOTAL
NI	22	8.0	163	3.586,00
N2	6	10.0	60	600,00
N3	1	8.0	80	720,00
N4	1	8.0	80	720,00
N5	2	8.0	160	1.440,00
N6	1	8.0	80	720,00

Ø	COMPON	PESOS(KG)
8.0	12.702,00	60,34
10.0	978,00	3,48
TOTAL	PESOS(KG)	64,82

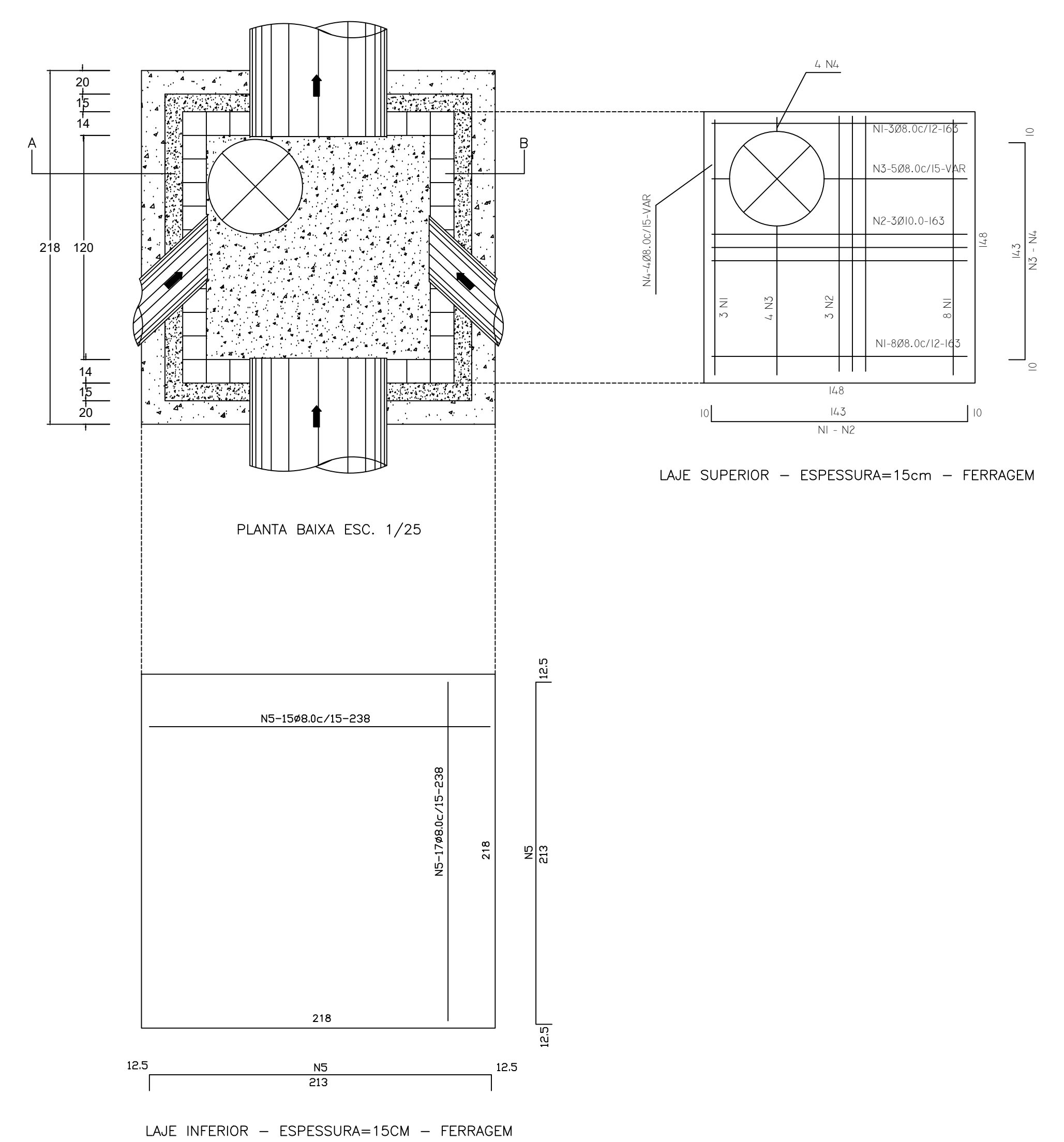
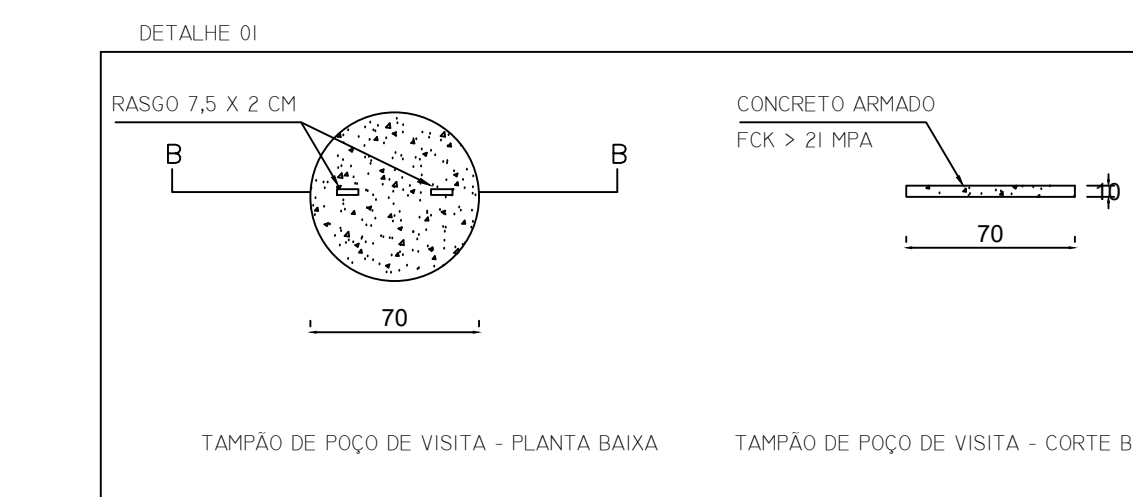

DETALHAMENTO MEIO SEM E COM SARJETA

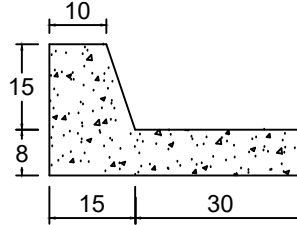
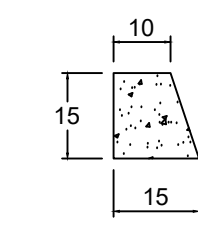
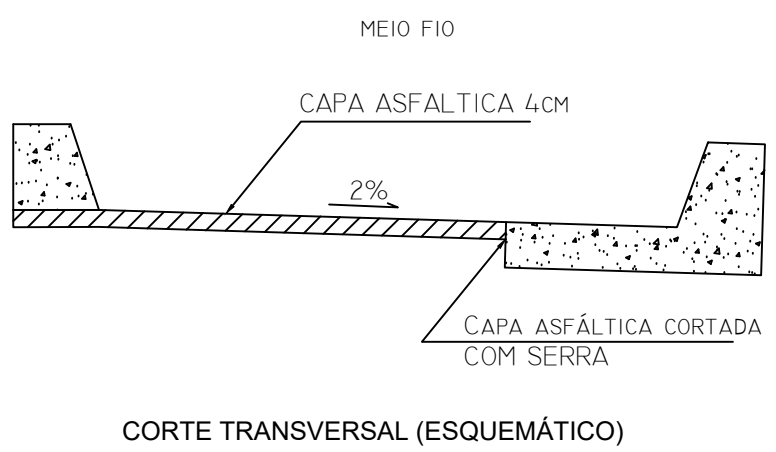

POSICAO	QUANT	#	UNID(M)	TOTAL
NI	2	8.0	160	1.440,00
N2	1	10.0	100	900,00
N3	1	10.0	100	900,00
N4	1	10.0	100	900,00
N5	1	10.0	100	900,00
N6	1	10.0	100	900,00

Ø	COMPON	PESOS(KG)
8.0	12.702,00	60,34
10.0	978,00	3,48
TOTAL	PESOS(KG)	64,82

DETALHAMENTO POÇO DE VISITA PARA REDE DE 1000MM

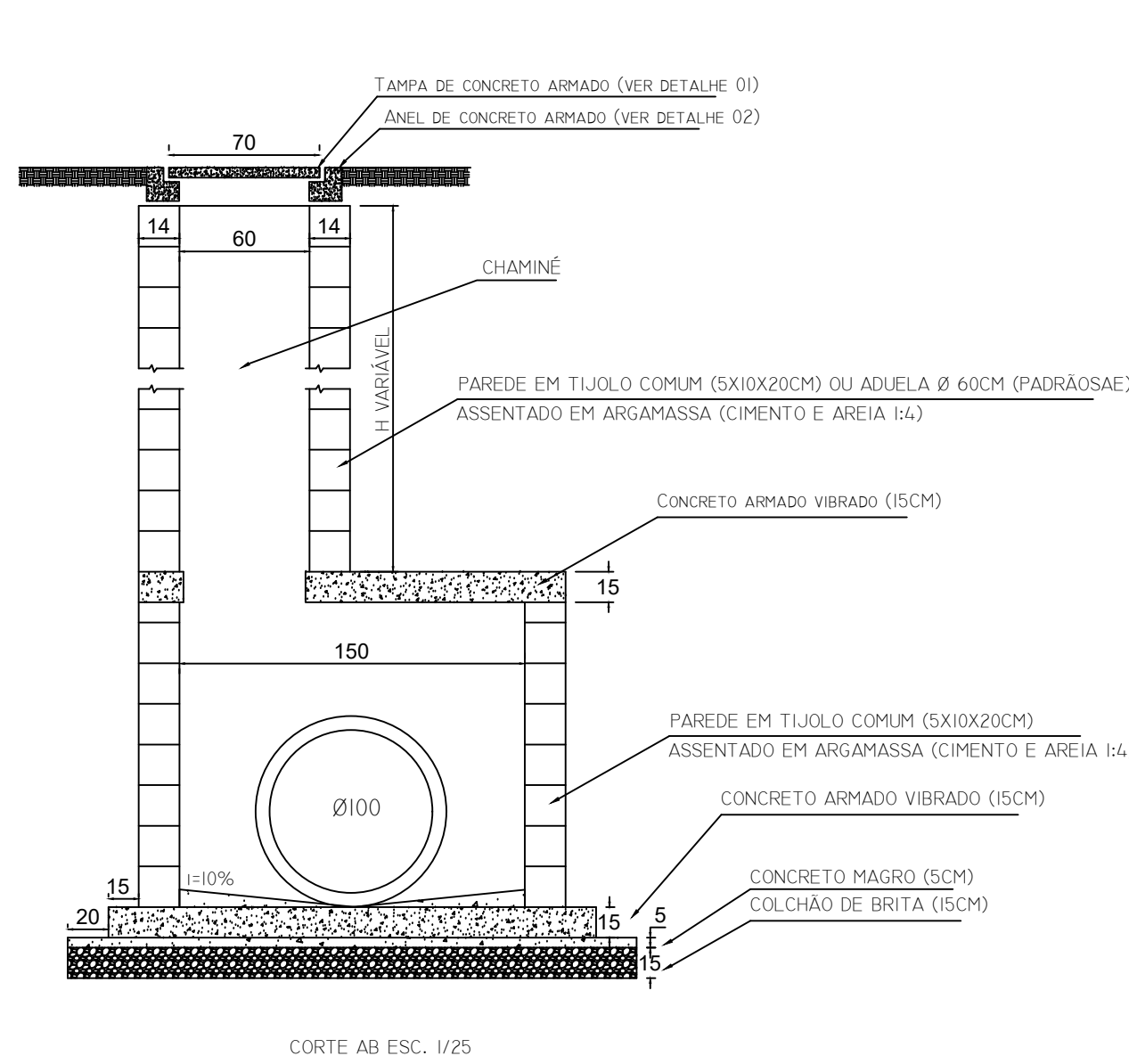

- POÇO DE VISITA EM BLOCO DE CONCRETO (14X19X20CM) PARA SAÍDA EM TUBO Ø 60 X 80 CM
(CONCRETO DO BLOCO FCK > 20 MPa)
- DIMENSÕES INTERNAS DA CAIXA: 100 X 100 CM

POSICAO	QUANT	#	UNID(M)	TOTAL
NI	22	8.0	163	3.586,00
N2	6	10.0	60	600,00
N3	1	8.0	80	720,00
N4	1	8.0	80	720,00
N5	2	8.0	160	1.440,00
N6	1	8.0	80	720,00

Ø	COMPON	PESOS(KG)
8.0	12.702,00	60,34
10.0	978,00	3,48
TOTAL	PESOS(KG)	64,82

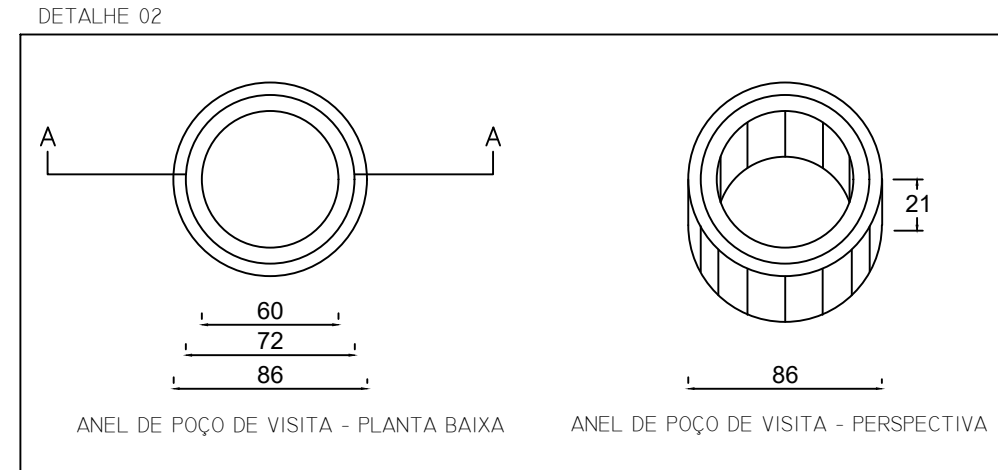
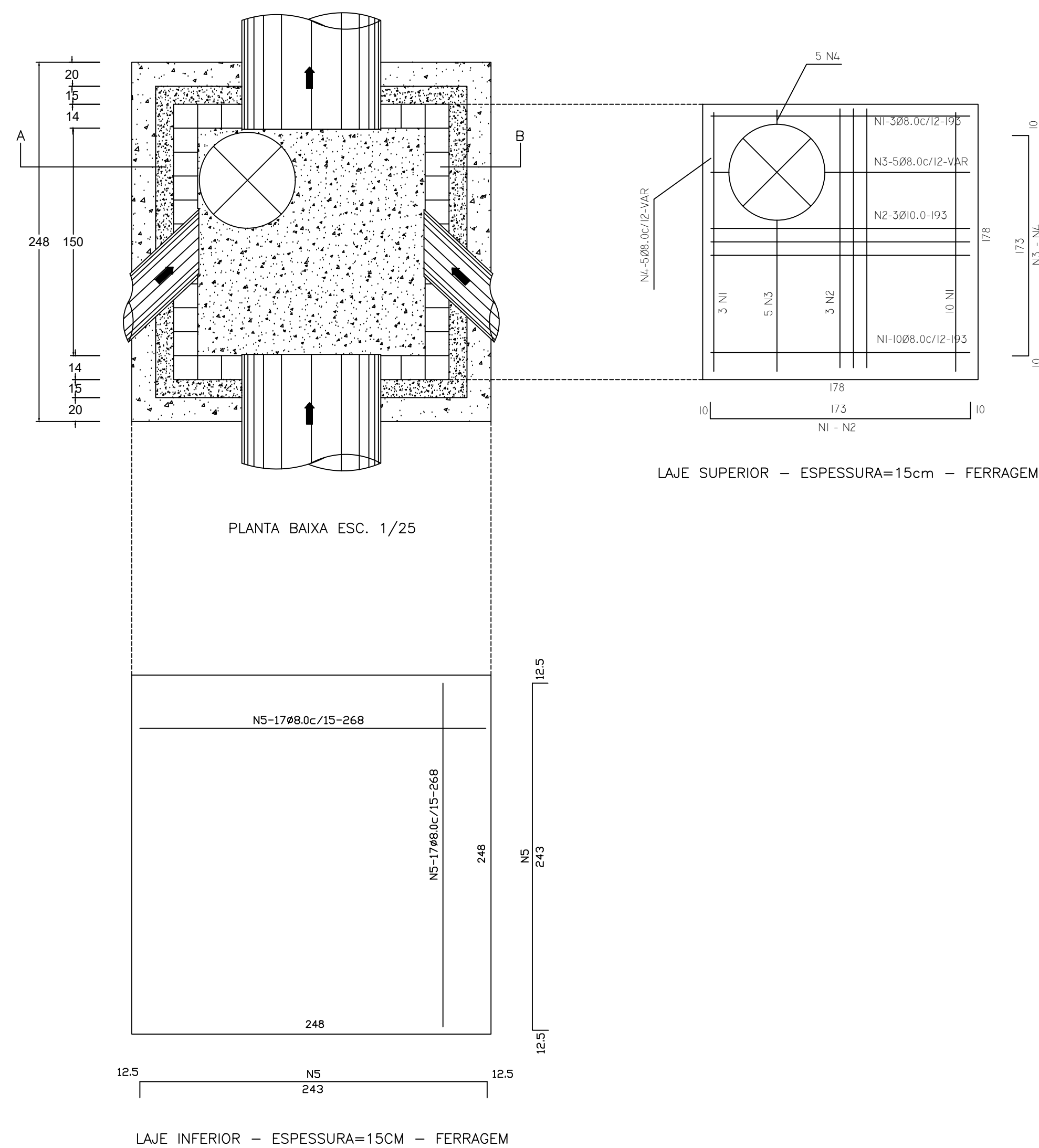
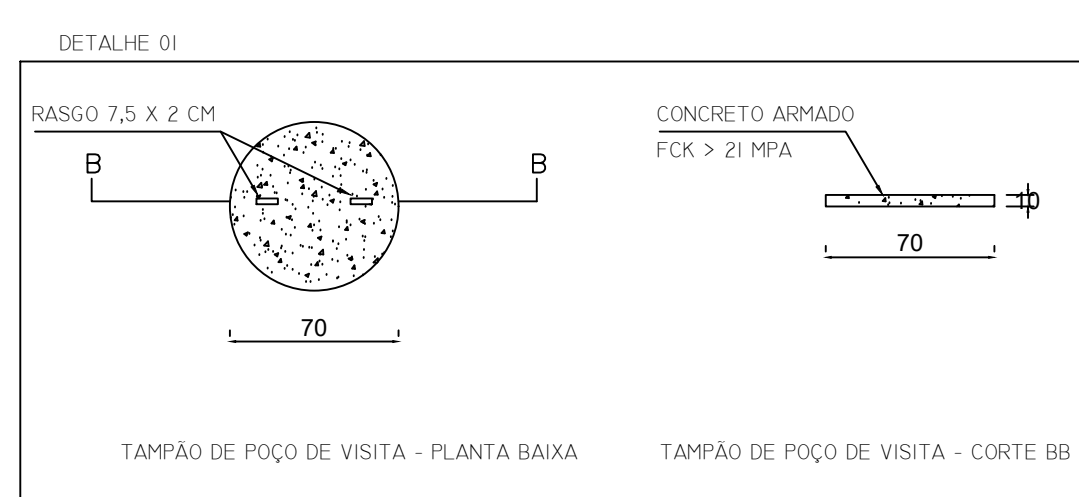

REDES TUBULARES DE CONCRETO

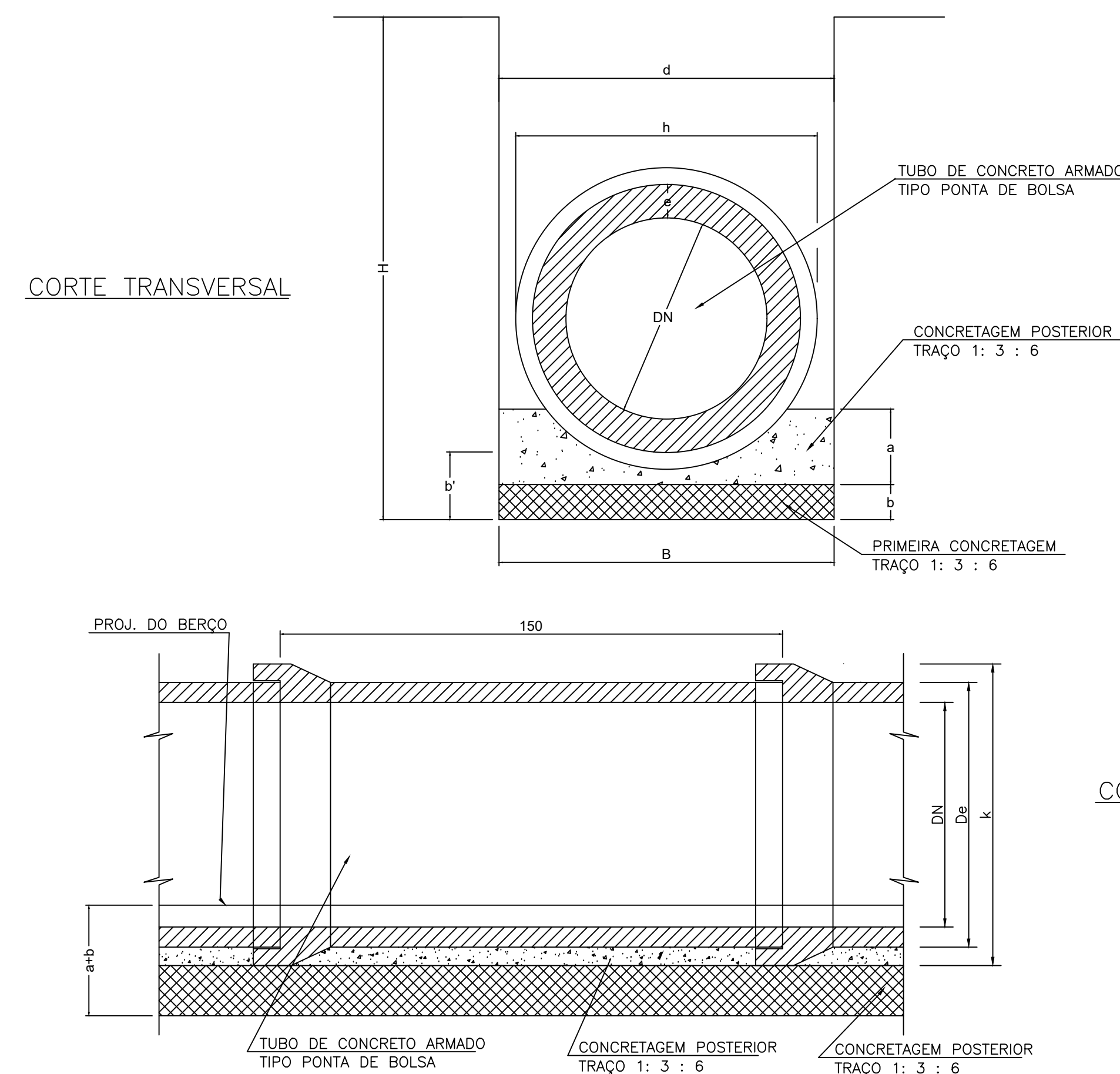

QUANTIDADES									
BERÇO PARA REDES TUBULARES									
DN (mm)	a (cm)	b (cm)	b' (cm)	d (cm)	REG/ APLACAMENTO m ² /m	CONCRETO 1: 3 : 6 m ³ /m	FORMA m ² /m	REATERRO MANUAL m ³ /m	
400	12	10	6.5	80	0.80	0.13	0.44	0.30	
500	15	13	9	100	1.00	0.21	0.56	0.29	
600	18	15	10.5	100	1.00	0.25	0.66	0.41	
700	21	18	12.5	110	1.10	0.32	0.78	0.47	
800	24	20	12.5	130	1.30	0.43	0.88	0.61	
900	27	23	15.5	140	1.40	0.52	1.00	0.68	
1000	30	25	15.5	160	1.60	0.66	1.10	0.85	
1100	33	28	18.5	170	1.70	0.77	1.22	0.92	
1200	36	30	20	190	1.90	0.94	1.32	1.12	
1300	39	33	23	200	2.00	1.07	1.44	1.21	
1500	45	36	27	240	2.40	1.50	1.66	1.30	

LARGURA DE VALAS ESC. EM CAIXÃO		
DN (mm)	H (m)	B (m)
400	≤ 1.50	0.80
	> 1.50	0.90
600	≤ 1.50	1.00
	> 1.50	1.30
800	≤ 1.50	1.30
	> 1.50	1.60
1000	≤ 1.50	1.60
	> 1.50	1.90
1200	≤ 1.50	1.90
	> 1.50	2.20
1500	≤ 1.50	2.40
	> 1.50	2.70

CARIMBO DE APROVAÇÕES:



LICENGE
ENGENHARIA & CONSULTORIA

TIPO DE USO:

Infraestrutura - Lagoa Paquetá

ENDEREÇO DA OBRA:
Sec. Mun. de Meio Ambiente de Catalão - SEMMAC

Av. Castelo Branco C/ Rua Paquetá, Cond. Paquetá

PROPRIETÁRIO:

PREFEITURA MUNICIPAL DE CATALÃO - SEMMAC CNPJ: 01.505.643/0001-50

AUTOR DO PROJETO:

ENGRº PEDRO SILVA DE SOUZA CREA nº: 1016279248/D-GO

RESPONSÁVEL TÉCNICO:

ENGRº PEDRO SILVA DE SOUZA CREA nº: 1016279248/D-GO

DESCRIÇÃO:

* Detalhes

* Armadura

* Legenda

ESCALA:

INDICADAS

DATA:

02 / 06 / 2021

DESENHO:

PEDRO

(64) 3443-1688

REVISÃO:

29 / 03 / 2023